

Report prepared by:

Every client, home and market demands it's own strategy. What is yours?

*Contact Chris Dowell,  
Today!*

(913) 712-9313

(913) 254-2470

[www.JohnsonCountyConnect.com](http://www.JohnsonCountyConnect.com)

[www.Google.com/+ChrisDowell](http://www.Google.com/+ChrisDowell)



**ReeceNichols**  
REAL ESTATE



**ReeceNichols**  
REAL ESTATE

MARKET ACTIVITY REPORT

# Amber Hills Estates in Olathe, KS

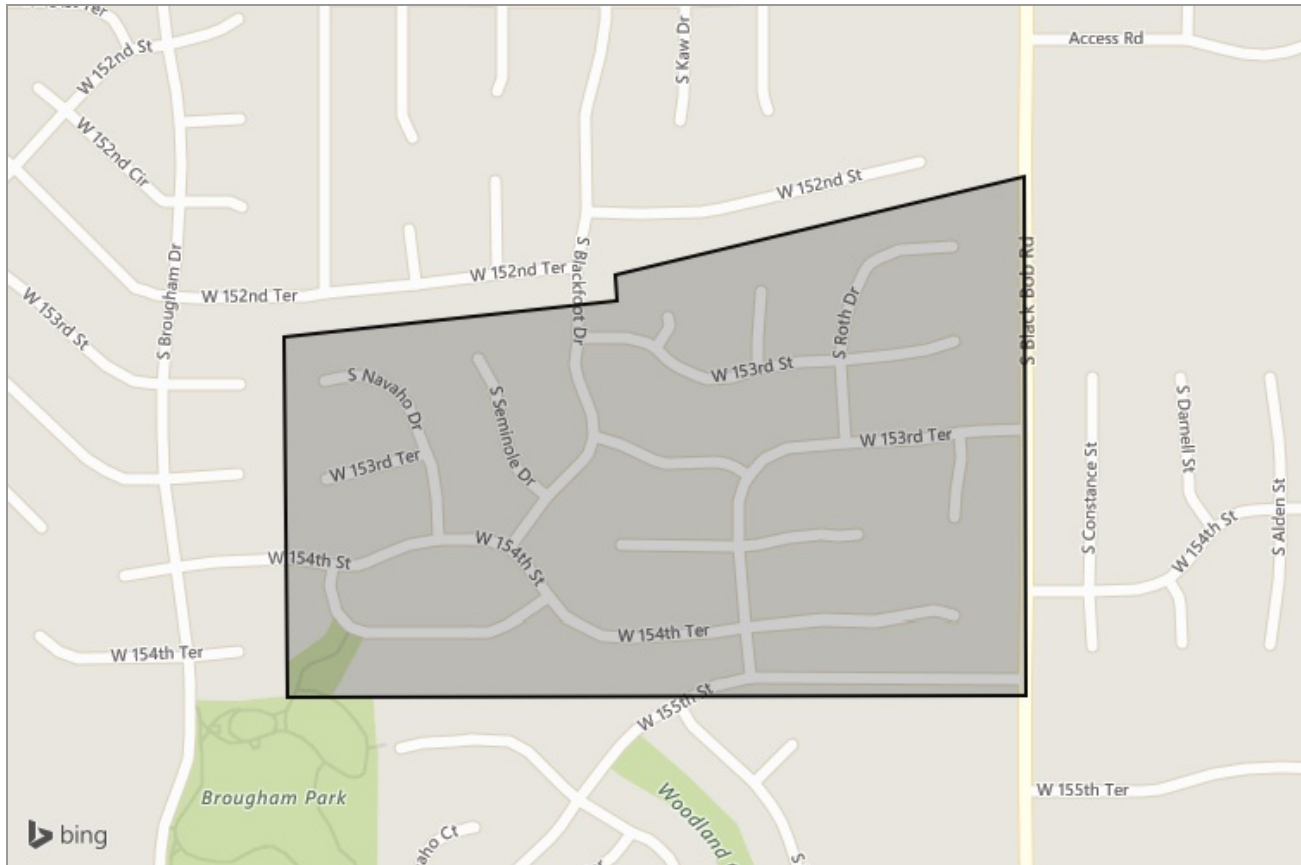

Presented by

**Chris Dowell**

Kansas Real Estate License: SP00043224



ReeceNichols  
REAL ESTATE

Mobile: (913) 712-9313 | Office: (913) 254-2470 | Fax: (913) 905-4980

[Chris@ReeceNichols.com](mailto:Chris@ReeceNichols.com)  
<http://Chris.ReeceNichols.com>

ReeceNichols Real Estate  
2140 E. Santa Fe Street  
Olathe, KS 66062



# Amber Hills Estates in Olathe, KS

## Estimated Home Values

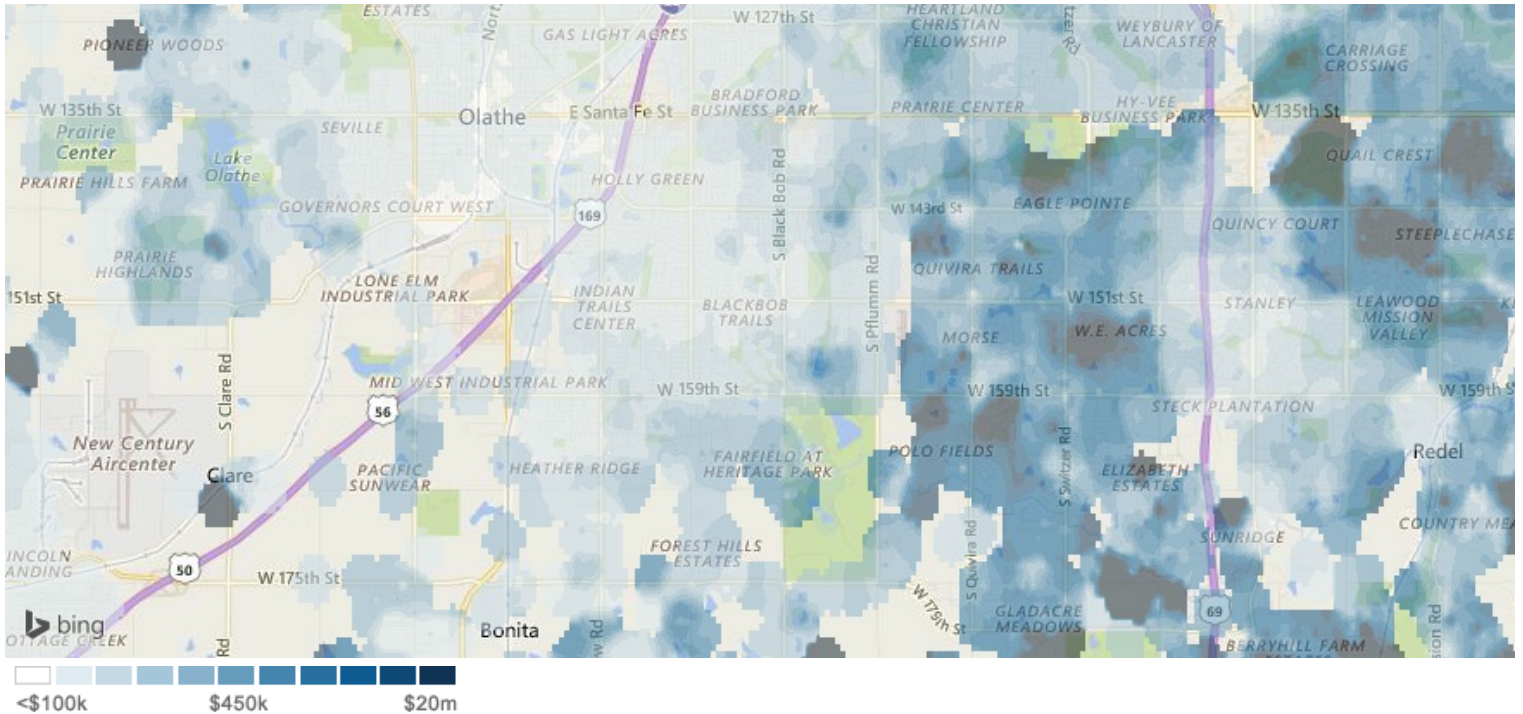

This map layer shows the average estimated home values, based on the AVMs and RVMs® for properties in an area. Source(s): Public records and MLS data where licensed; updated Quarterly.

## Market Snapshot

Compared with Last Year: January 19, 2016 vs. January 19, 2017

Median Est. Home Value

**\$264K**

Up 4.5%

Median Est. Listing Price

Median Days in RPR

**58**

Down -74.8%

Sales Volume

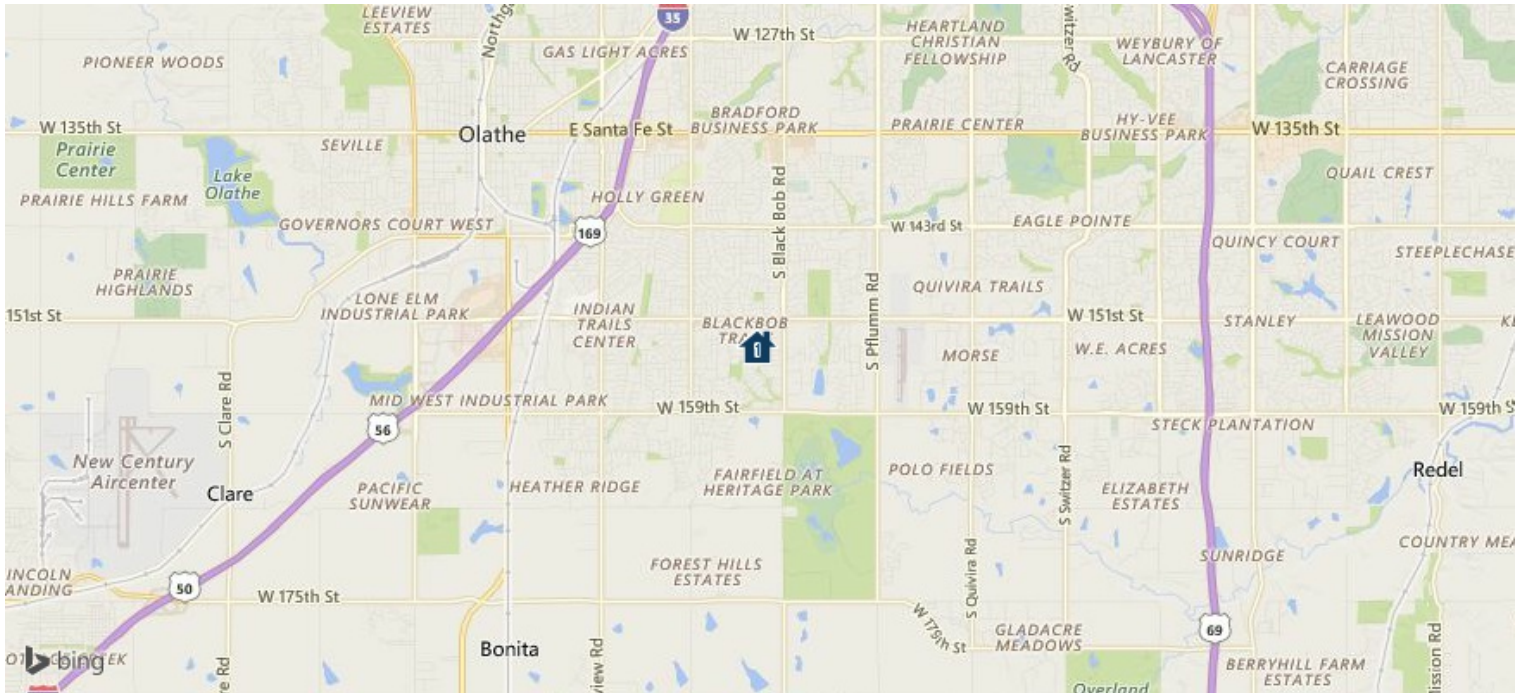

Pending Listings: 1

	Prop Type	Bed /Ba	Living Area (sq ft)	Lot Size (sq ft)	Listing Date	Listing Price	Pending Date	Price per sq. ft.
 <span>1</span> <span>13</span> PENDING • Show For Backups: 1/14/2017 MLS ID: 2025745 <b>15313 S Blackfoot Dr</b> FINALLY A HOUSE FOR SALE IN AMBER HILLS ESTATES. GREAT FLOOR PLAN WITH LARGE KITCHEN THAT HAS WHITE CABINETS FOR TODAY'S BUYERS. CENTER ISLAND AND OPEN TO GREAT ROOM WITH INVITING FIREPLACE. THE MASTER BEDROOM FEATURES A SITTING ROOM AND TUB AND SHOWER WITH DOUBLE VANITY. FORMAL DINING ROOM IS FLEXIBLE BASED ON YOUR FURNITURE. COULD BE LIVING ROOM OR LIBRARY. BASEMENT IS READY TO FINISH, STUD WALLS IN AND HALF BATH HAS BEEN STUBBED. HURRY THIS SPOTLESS HOME IS A BLANK CANVASS AND READY TO MOVE IN WITH YOUR DECOR. <i>Listing Courtesy of Char MacCallum Real Estate</i>	Single Family	4/3	2,383 sq ft	10,040	1/11/2017	\$289,500	1/14/2017	\$121

## Kansas City Title

**KANSAS CITY TITLE**

Office:(913) 345-4500  
Fax:(913) 345-0216

**Kansas Closing Center**  
6600 College Blvd  
Suite 200  
Overland Park, KS 66211

[www.kansascitytitle.com](http://www.kansascitytitle.com)

*Kansas City Title's focus is providing quality, service, and value to its customers.*

## HomeServices Lending

**HomeServices Lending<sup>LLC</sup>**

**Contact:**  
**Michelle Rusnak**  
[micheller@hslkc.com](mailto:micheller@hslkc.com)  
Office:(913) 663-2999  
Fax:(844) 253-3674

**NMLS# 1307319**  
**2140 E. Santa Fe Street**  
**Olathe, KS 66062**  
[www.MichelleRusnak.com](http://www.MichelleRusnak.com)

## Reece &amp; Nichols Insurance

**REECE & NICHOLS** Insurance

**Contact:**  
**Troy Jefferson**  
[Troy.Jefferson@ReeceNichols.com](mailto:Troy.Jefferson@ReeceNichols.com)  
Office:(913) 266-5636

**11601 Granada**  
**Leawood, KS 66211**

[www.reecenichols.com/pages/services/home-insurance](http://www.reecenichols.com/pages/services/home-insurance)

*Reece & Nichols Insurance, LLC is an independent insurance agency that is committed to helping you find the best possible insurance policy for your new home.*

NOTE: This communication is provided to you for informational purposes only and should not be relied upon by you. The real estate firm identified on this report is not a mortgage lender and so you should contact the mortgage company identified above directly to learn more about its mortgage products and your eligibility for such products.